

# MASTER LAYOUT PLAN OF ATAL BIHARI VAJPAYEE ZOOLOGICAL PARK IN BILIKAL WEST RESERVE FOREST AREA NEAR KAMLAPUR, HOSPET TALUK, BELLARY (DIST) KARNATAKA.

(RELOCATION OF EXISTING MINI ZOO FROM BELLARY)

SCALE = 1:3000

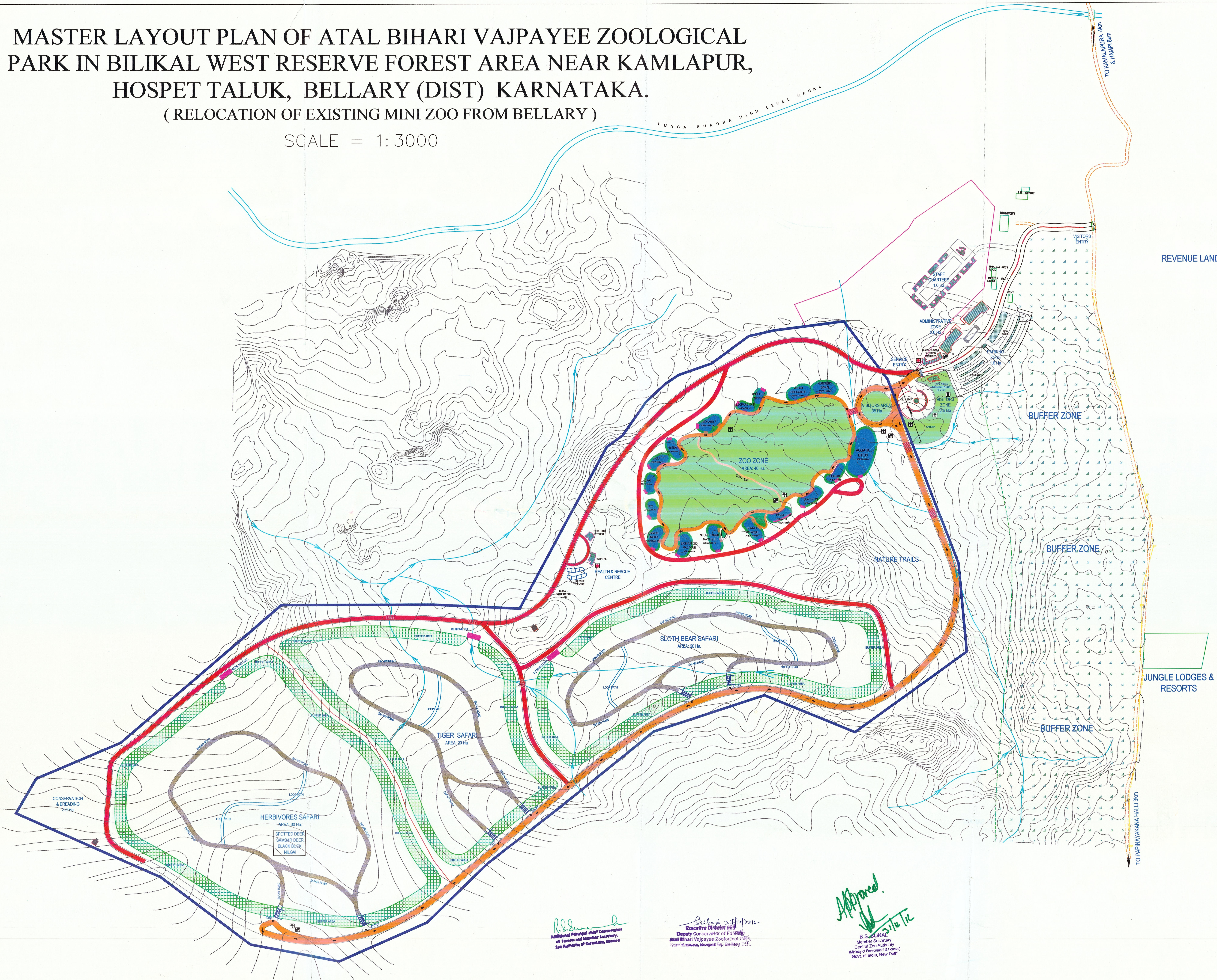

**NOTES: -**  
 - ALL DIMENSIONS ARE IN METERS  
 - THIS DRAWING IS A COPYRIGHT AND PROPERTY OF THE CONSULTANT, IS NOT TO BE PRODUCED, COPIED, HANDED OVER TO THIRD PARTY OR USED FOR ANY OTHER PURPOSE OTHER THAN FOR WHICH IT IS INTENDED.  
 - ALL DIMENSIONS SHALL BE VERIFIED ON SITE PRIOR TO START OF WORK. ANY DISCREPANCY SHALL BE BROUGHT TO THE NOTICE OF THE CONSULTANT.  
 - THE CONSTRUCTION MANAGER/CONTRACTOR MUST CHECK ALL DIMENSIONS AND DETAILS AND BE RESPONSIBLE FOR THE SAME. ANY DISCREPANCY SHALL BE BROUGHT TO THE NOTICE OF THE ARCHITECT.  
 - THIS DRAWING IS TO BE READ AND NOT SCALED.  
 - THIS DRAWING SHALL BE READ IN CONJUNCTION WITH ALL RELEVANT ARCHITECTURAL, STRUCTURAL AND SERVICES DRAWINGS. ANY DISCREPANCY NOTICED SHALL BE BROUGHT TO THE ATTENTION OF THE CONSULTANTS  
 - DRAWING APPROVAL IS FOR THE CONFORMITY WITH OUTLINE DESIGN INTENT ONLY AND DOES NOT RELIEVE THE PROJECT MANAGERS / CONTRACTORS / SUBCONTRACTORS FROM FULL RESPONSIBILITY FOR THE ACCURACY, INTEGRATION AND FITNESS FOR PURPOSE OF DESIGN

AREA	
TOTAL AREA = 141.6 Ha	
ZOO ZONE	48.0 Ha
SAFARI ZONE	70.0 Ha
CONSERVATION & BREEDING	3.0 Ha
OTHERS	13.4 Ha
VISITORS ZONE	2.6 Ha
ADMINISTRATIVE ZONE	2.0 Ha
STAFF QUARTERS	1.0 Ha
PARKING ZONE	1.6 Ha

LEGEND	
[Symbol]	BOUNDARY
[Symbol]	CONTOUR
[Symbol]	VISITORS ROAD
[Symbol]	SERVICE ROAD
[Symbol]	SAFARI ROAD
[Symbol]	APPROACH ROAD
[Symbol]	NEW ENCLOSURES
[Symbol]	BUFFER AREA
[Symbol]	BUFFER ZONE
[Symbol]	CULVERT
[Symbol]	NALLA
[Symbol]	BUILDINGS
[Symbol]	RETIRING AREA
[Symbol]	LANDSCAPED AREA
[Symbol]	TUNGABHADRA CANAL
[Symbol]	WILD LIFE AREA
[Symbol]	DOUBLE GATE ENTRY SYSTEM
[Symbol]	VIEWING AREA
[Symbol]	MOAT
[Symbol]	HOSPITAL & FIRST AID
[Symbol]	RESTAURANTS
[Symbol]	TOILETS
[Symbol]	SHELTERS

CLIENT :  
**KARNATAKA FOREST DEPARTMENT, BELLARY.**

PROJECT :  
**ATAL BIHARI VAJPAYEE ZOOLOGICAL PARK, HOSPET TALUK, BELLARY (DIST) KARNATAKA.**

TITLE :  
**MASTER LAYOUT PLAN**

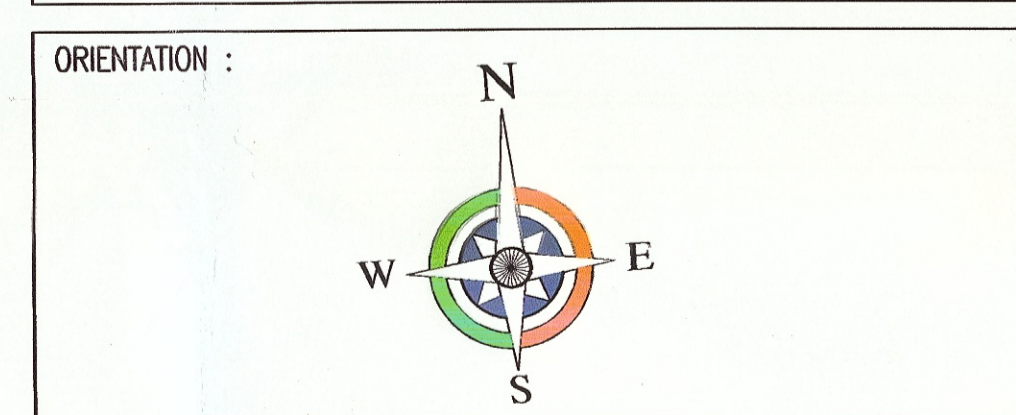

SCALE:	1:3000	DWG No.	MP-06
DEALT:	HARI R		
R.DATE:	27-12-12		

ARCHITECTS :  
**De Force**  
 # 53, 6th CROSS, NARAYANAPPA BLOCK, BENSON TOWN, BANGALORE - 560 046.  
 EMAIL: mail.deforce@gmail.com  
 Ph. 9341010017 / 080 23540017

*R.S. Srinivas*  
 Additional Principal Chief Conservator of Forests and Member Secretary, Zoo Authority of Karnataka, Bangalore

*S. Srinivas*  
 Executive Director and Deputy Conservator of Forests, Atal Bihari Vajpayee Zoological Park, Kamalapur, Hospet Taluk, Bellary District, Karnataka

*Approved*  
 B. S. Srinivas  
 Member Secretary, Central Zoo Authority, Ministry of Environment & Forests, Govt. of India, New Delhi

DAROU SLOTH BEAR SANCTUARY APPROXIMATELY 2.0 KM FROM PAPIYAKANA HALLI - KAMALAPUR ROAD

REVENUE LAND

JUNGLE LODGES & RESORTS

TO KAMALAPURA 4km & HAMP 8km  
 TO PAPIYAKANA HALLI 3km